



PREMIER UNFINISHED OAK CABINETS

KITCHEN, BATHROOM, LAUNDRY, STORAGE, OFFICE, GARAGE

WALL CABINETS

* SPECIAL ORDER SIZES ONLY

SINGLE DOOR SKU

- 12W X 30H X 12D- 4794011
- 15W X 30H X 12D- 4794024
- 18W X 30H X 12D- 4794037
- 21W X 30H X 12D- 4794040
- 24W X 30H X 12D- 4794053



DOUBLE DOOR SKU

- *27W X 30H X 12D-4794054
- 30W X 30H X 12D- 4794079
- *33W X 30H X 12D-4794080
- 36W X 30H X 12D- 4794095



**DIAGONAL SKU

- 24W X 30H X 12D- 4794215



WDC24

ALLOW 24" OF WALL SPACE

**BLIND CORNER SKU

- 24W X 30H X 12D- 4794202

XCW24

ALLOW UP TO 27" OF WALL SPACE



**LAUNDRY SKU

- 54W X 24H X 12D- 4794228

LC54



DOUBLE DOOR SKU

- 30W X 18H X 12D- 4794189



DOUBLE DOOR SKU

- 30W X 12H X 12D- 4794195
- 30W X 15H X 12D- 4794176
- 36W X 12H X 12D- 4794198
- 36W X 15H X 12D- 4794192



BASE CABINETS

* SPECIAL ORDER SIZES ONLY

SINGLE DOOR SKU

- 12W X 34.5H X 24D- 4794260
- 15W X 34.5H X 24D- 4794273
- 18W X 34.5H X 24D- 4794286
- 21W X 34.5H X 24D- 4794299
- 24W X 34.5H X 24D- 4794309



DOUBLE DOOR SKU

- *27W X 34.5H X 24D-4794310
- 30W X 34.5H X 24D- 4794325
- *33W X 34.5H X 24D-4794326
- 36W X 34.5H X 24D- 4794341



DRAWER BASE SKU

- * 12W X 34.5H X 24D- 4794421
- 15W X 34.5H X 24D- 4794422
- 18W X 34.5H X 24D- 4794435
- *24W X 34.5H X 24D- 4794436



SINK BASE SKU

- *30W X 34.5H X 24D-4794463
- *33W X 34.5H X 24D-4794465
- 36W X 34.5H X 24D- 4794464



SINK BASE SKU

- 60W X 34.5H X 24D- 4794477



**BLIND CORNER SKU

- 36W X 34.5H X 24D- 4794480

BC36

ALLOW UP TO 36" OF WALL SPACE



**LAZY SUSAN SKU

- 36W X 34.5H X 24D- 4794493

LS36

ALLOW 36" OF WALL SPACE

VISIT OUR WEBSITE FOR INSTALLATION INSTRUCTIONS

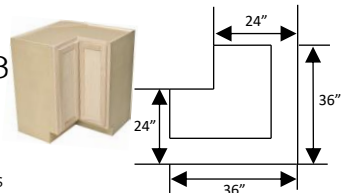

ACCESSORIES

- WALL END PANEL (WEP)- 4794561
- BASE END PANEL (BEP)- 4794558
- UTILITY END PANEL (UEP)- 4794574
- TOE KICK (TK96)- 4794600
- UNIVERSAL FILLER (UF330)- 4794587

TALL CABINET

* SPECIAL ORDER SIZES ONLY

UTILITY

- * 15W X 84H X 24D-4794502
- 18W X 84H X 24D- 4794503
- *24W X 84H X 24D-4794504



**Actual Cabinet Dimensions

	W	H	D
WDC24	24	30	12
XCW24	24	30	12
BC36	30	34 ½	24
LS36	30	34 ½	18
LC54	54	23 ½	12

Quality One Woodwork provides you with a full line of unfinished cabinets for a variety of uses. All cabinets are assembled and ready to install allowing you the hardware and finish of your choice. Start your project by planning your cabinet configuration using the grid below.

HOW TO DESIGN YOUR PROJECT

- 1. Measure The Entire Room-** Using the grid below, record the length of each wall in your room. Make sure to include the breaks in the walls such as doors and windows. Also indicate placement of the fixtures, such as air vents and permanent appliances, by measuring from the centerline of the plumbing, ducting and outlets.
- 2. Create The Floor Plan-** Using the measurements on the grid, begin inserting cabinets into the plan with the sizes available on the reverse side of this sheet. If your project has a corner, start in the corner and work in both directions.
- 3. Review Your Layout-** Prior to purchasing, take a few minutes to review your layout ensuring measurements are correct and you have accounted for all items to be placed in your design.

1 Small Square = 3 inches or 1 Large Square = 2 ft

